

SR. TRAY™

EXPANDED POLYSTYRENE RIGID INSULATION FORM FOR MONOLITHIC SLAB

The SR.Tray™ forms produced by Styro Rail Inc. are composed of type 3 expanded polystyrene [EPS] rigid insulation and offers a compressive strength of 276 kPa [40 PSI].

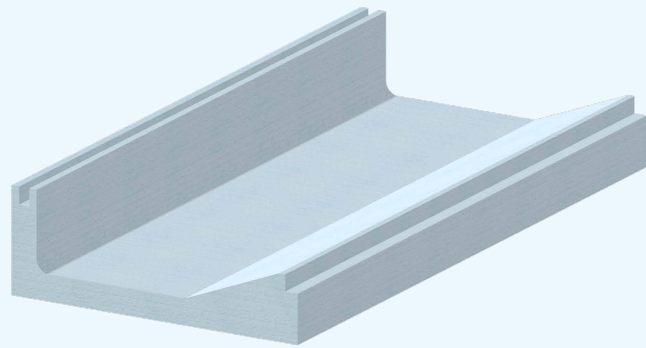

- +** **CHARACTERISTICS**
- COMBINATION OF THE INSULATION AND FORMWORK STEPS
- SIMPLIFIED ALIGNMENT WITH NOTCHES FOR FURRING STRIPS
- ELIMINATES THERMAL BRIDGES WITH A CONTINUOUS INSULATION UNDER THE FOOTING
- VERY HIGH COMPRESSIVE STRENGTH
- INERT MATERIAL WHICH DOES NOT CONTAIN ORGANIC MATTER - NOT AFFECTED BY SOIL OR GROUNDWATER
- 100% RECYCLABLE MATERIAL
- MEETS CAN/ULC-S701.1 STANDARD

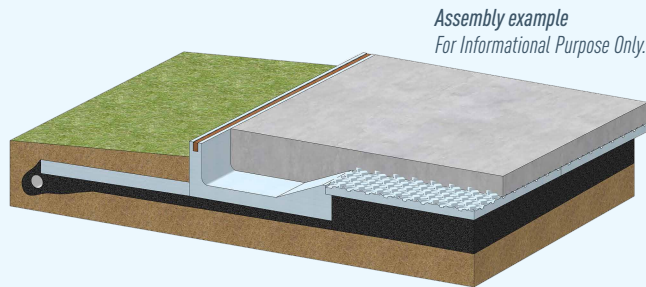

SR. TRAY™ **EXPANDED POLYSTYRENE RIGID INSULATION FORM FOR MONOLITHIC SLAB**

AVAILABLE DIMENSIONS

EPS (254 mm x 102 mm)	Concrete (152 mm x 102 mm)	EPS (10" x 4")	Concrete (6" x 4")	R17.2
EPS (305 mm x 102 mm)	Concrete (203 mm x 102 mm)	EPS (12" x 4")	Concrete (8" x 4")	R17.2
EPS (330 mm x 102 mm)	Concrete (229 mm x 127 mm)	EPS (13" x 4")	Concrete (9" x 5")	R17.2
EPS (356 mm x 102 mm)	Concrete (254 mm x 127 mm)	EPS (14" x 4")	Concrete (10" x 5")	R17.2
EPS (406 mm x 102 mm)	Concrete (305 mm x 152 mm)	EPS (16" x 4")	Concrete (12" x 6")	R17.2
EPS (457 mm x 102 mm)	Concrete (356 mm x 152 mm)	EPS (18" x 4")	Concrete (14" x 6")	R17.2

Other dimensions available upon request. Width and length by default : 46" x 96" (1168 mm x 2438 mm).

LÉGENDE

EPS (AxB) Concrete (CxD)

- A: Height of the tray (EPS)
- B: Thickness of the tray wall (EPS)
- C: Thickness of the footing (Concrete)
- D: Thickness of the slab (Concrete)

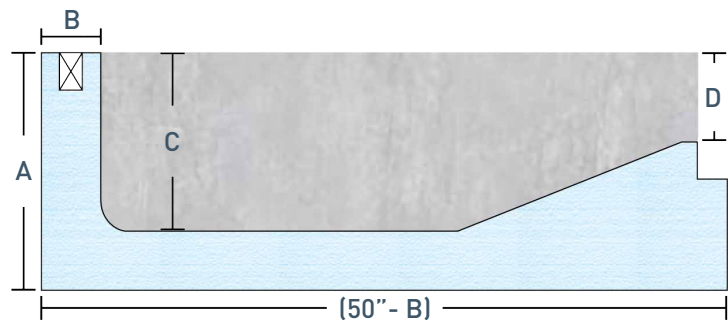

RECOMMENDED USE

Install SR.Tray™ forms on non altered soil covered with leveled drainage gravel before pouring the footings concrete in order to limit the frost penetration. Ideal for slabs-on-grade, detached garages or when a very high compressive strength is required.

CERTIFICATION

Warnock Hersey has certified the type 3 expanded polystyrene contained in SR.Tray™ forms in accordance with the CAN/ULC-S701.1 standard. The type 3 expanded polystyrene produced by STYRORAIL™ is listed in the CCMC Registry of Product Evaluation under CCMC 13277-L.

ENVIRONMENTAL DATA

The expanded polystyrene used in the making of the SR.Tray™ forms are composed of 98% air and 2% plastic material. They are manufactured without HCFC, HFC gases and without HBCD flame retardant.

The STYRORAIL™ products can contribute to LEED credits.

Please send us your LEED Material Declaration Form at projetleed@styorail.ca.

LIMITATIONS

Expanded polystyrene is combustible. Even if expanded polystyrene contains a flame retardant, limit use of open flame or ignition sources near product. A protective barrier or thermal barrier is required as specified in the appropriate building code.

Expanded polystyrene may be affected by some oil based solvents.

SR. TRAY™ **EXPANDED POLYSTYRENE RIGID INSULATION FORM FOR MONOLITHIC SLAB**

PHYSICAL PROPERTIES

INSULATING PANEL	SR.P400 ^{MD}
Type	3
Min. Thermal Resistance [ASTM C518] Thickness of 25 mm [1"]	RSI 0,76 [R4.3]
Max. MVTR [ASTM E96]	130 ng/Pa·s·m ² [2.27 US Perms]
Min. Compressive Strength [ASTM D1621] 10% Deformation	276 kPa [40 PSI]
Min. Flexural Strength [ASTM C203]	414 kPa [60 PSI]
Max. Water Absorption [ASTM D2842] Volume	1.5 %
Max. Dimensional Stability [ASTM D2126] Linear Variation	1.5 %
Min. Limiting Oxygen Index [ASTM D2863]	24 %
Min. Density [ASTM C303]	39 kg/m ³ [2.4 lbs/ft ³]
Flame Spread Rating [CAN/ULC S102.2]	145

STORAGE

Store SR.Tray™ forms in a dry and ventilated location, protected from the outside elements, ultraviolet rays, open flames or other sources of ignition. Stack forms on pallets of minimum 100 mm [4"] over the ground.

INSTALLATION

Forms must be dry and in good condition before installation.

To limit the color loss from UV exposure, backfill SR.Tray™ forms as soon as possible.

Refer to the *Installation Guide* for more information.

EXEMPTION OF LIABILITY

The information herein is based on the present state of our best scientific and practical knowledge. The user is responsible for checking the suitability of products for their intended use and to validate the appropriate formats with a certified professional. STYRORAIL™ is not responsible for determining the required footing, slab and reinforcing chairs dimensions. STYRORAIL™ technical data sheets are updated on a regular basis; it is the user's responsibility to obtain and to confirm the most recent version. Information contained in this data sheet may change without notice.